

圆筒帽形熔断器支持件/底座 Cylindrical Fuse Holders



表 Table 10

序号 No.	产品型号 Model of product	配装熔断体 尺码 Applicable fuse link size	额定绝缘 电压(V) Rated insulation voltage	约定发热 电流(A) Conventional thermal current	重量 (g) Weight (g)	图号 Drawing No.	外形尺寸(mm) Overall dimension (mm)				
							A1	A2	B	H1	H2
1001	RT18-32(X)	10×38	500	32	59	10.1	79	81	18	61	80
1002	RT18B-10	8.5×23	500	10	59	10.1	80	82	18	60	78
1003	RT18B-16	10×25.8	500	16	59	10.1	80	82	18	60	78
1004	RT18B-20	8.5×31.5	500	20	59	10.1	80	82	18	60	78
1005	RT18B-25	10×31.5	500	25	59	10.1	80	82	18	60	78
1006	RT18B-32	10×38	500	32	59	10.1	80	82	18	60	78
1007	RT18 C-10	8.5×23	500	10	56	10.1	77	78	18	62	81
1008	RT18C-16	10×25.8	500	16	56	10.1	77	78	18	62	81
1009	RT18C-20	8.5×31.5	500	20	56	10.1	77	78	18	62	81
1010	RT18C-25	10×31.5	500	25	56	10.1	77	78	18	62	81
1011	RT18C-32	10×38	500	32	56	10.1	77	78	18	62	81
1012	RT18M-32	10×38	500	32	56	10.1	78	78	18	60	80
1012-1	RT18M-32N	10×38	690	32	56	10.1	78	78	18	60	80
1012-2	RT18W-32	10×38	690	32	64	10.1	81	81	17.5	57.5	80
1012-3	RT18W-63	14×51	690	63	97	10.1	94	94	27	68.5	110
1012-4	RT18W-125	22×58	690	125	158	10.1	120	120	36	69	110
1013	HG30-32	10×38	500	32	57	10.1	78	80	18	73	88
1014	RT18-63(X)	14×51	500	63	192	10.1	103	105	27	80	110

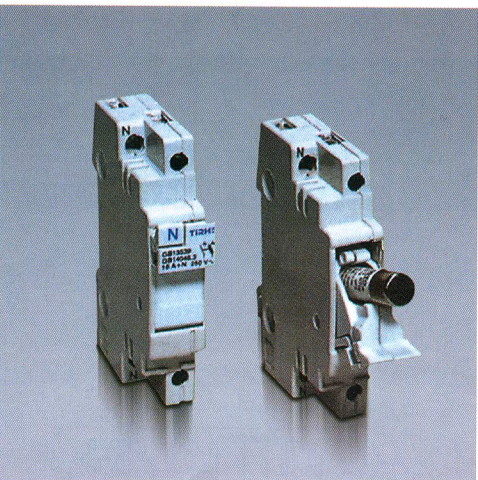
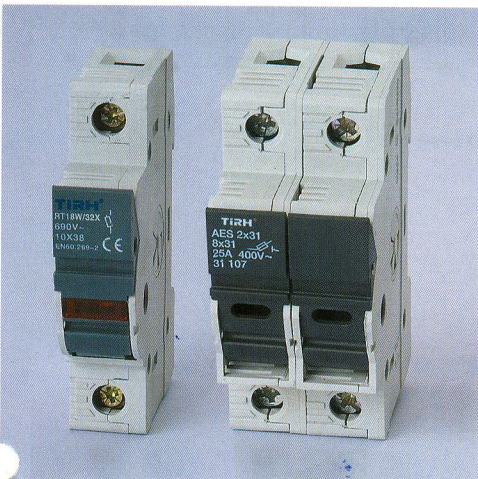
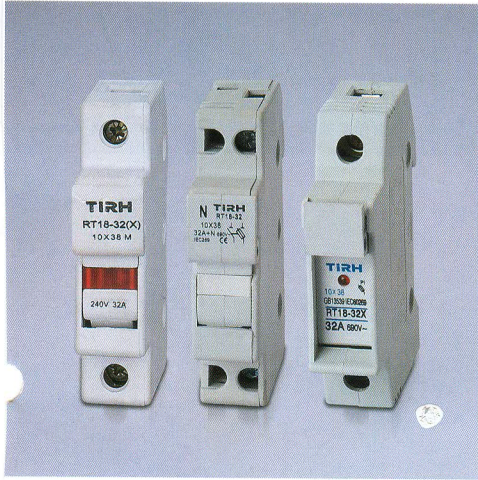
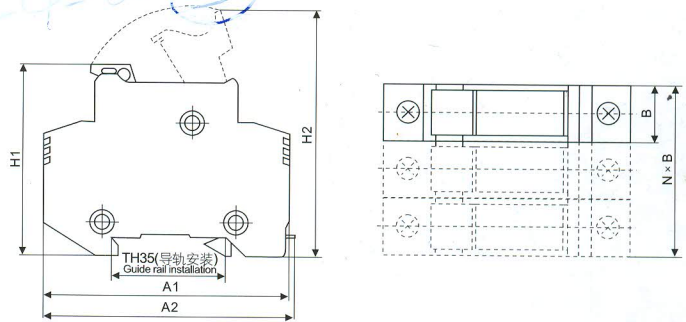

图Drawing 10.1

续表10 Table 10 continued

序号 No.	产品型号 Model of product	配装熔断体 尺码 Applicable fuse link size	额定绝缘 电压(V) Rated insulation voltage	约定发热 电流(A) Conventional thermal current	重量 (g) Weight (g)	图号 Drawing No.	外形尺寸(mm) Overall dimension (mm)
1015	RT18N-10	8.5 × 23	500	10	70	10.2	详细数据见图10.2 Refer to drawing 10.2 for detailed data
1016	RT18N-16	10 × 25.8	500	16	62	10.2	详细数据见图10.2 Refer to drawing 10.2 for detailed data
1017	RT18N-20	8.5 × 31.5	500	20	63	10.2	详细数据见图10.2 Refer to drawing 10.2 for detailed data
1018	RT18N-25	10 × 31.5	500	25	62	10.2	详细数据见图10.2 Refer to drawing 10.2 for detailed data
1019	RT18N-32	10 × 38	500	32	62	10.2	详细数据见图10.2 Refer to drawing 10.2 for detailed data

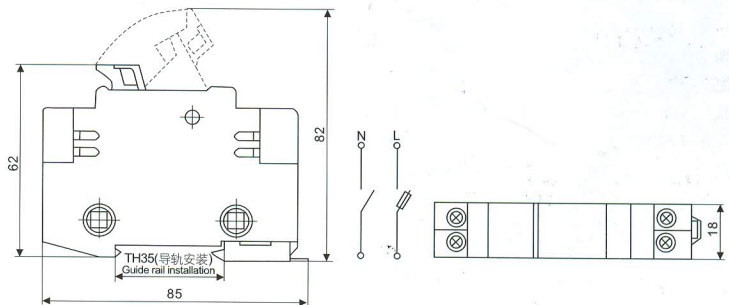

图Drawing 10.2

圆筒帽形熔断器支持件/底座 Cylindrical Fuse Holders



用途

本系列熔断器支持件适用于交流50Hz、额定绝缘电压至690V、约定发热电流至125A、主要用在电气线路中作为尺码至22×58的各种使用类别(gG、aM、aR等)的熔断体的支持件。本系列熔断器支持件具有耐受约定发热电流及预期短路冲击电流至100KA动热稳定的能力，多相组合后具有隔离电源的功能。其中型号为RT18N的熔断器支持件有一上一下两路进出线，兼有隔离电源的功能；RT18L带有安全锁扣装置，在断开状态可锁住载熔件，确保不发生误操作；还可带熔断指示灯，灯亮指示熔断体已熔断。

本系列熔断器支持件符合国家标准GB13539.1、GB13539.2、GB13539.6、GB14048.3和国际电工委标准 IEC60269-1、IEC60269-2、IEC60269-2-1、IEC947-3。

结构特点

本系列熔断器支持件由塑料压制的外壳装上触头和载熔件后，经铆接或焊接而成，均可组成多相结构。RT19为敞开式，其他型号都是半封闭式结构。其中RT18N、RT18B、和RT18C在同一外形尺寸的底座上，可供用户选择配置五种不同尺码的熔断体；RT18N有两路进出线，一路配置相应尺码的熔断体，另一路为一个双断点常开触头，单个支持件具有隔离电源的功能；RT18型支持件均为TH35mm的导轨式安装，其中RT18L还带有安全锁扣装置，确保支持件断开状态不发生误操作。

基本数据

产品型号、额定绝缘电压、约定发热电流、配置圆筒帽形熔断体尺码、外形尺寸见图10.1~10.12及表10(n相组合的宽度 $B_n = nB$):

Applications

These fuse holders are supporters for fuses with size up to 22×58mm. They are capable of working under heat caused by rated current and expected short impacting current up to 100KA. It can also function as a fuse disconnecting switch by multi-phase combination. There are two in/out lines at the RT18N fuse base, providing a power cut function. The RT18L type has a safety lock to lock the fuse carrier when disconnected to avoid wrong operation; it can also be equipped with an indicator, which goes on when the fuse links breaks.

Rated insulate voltage up to 690V; Working frequency 50Hz AC; Conventional free air thermal current up to 125A; Compliant with GB13539.1、GB13539.2、GB13539.6、GB14048.3 and IEC60269-1、IEC60269-2、IEC60269-2-1、IEC947-3.

Design Features

After the plastic-injected case is equipped with contacts and fuse links, the bases are formed by welding or riveting both capable of being multi-phase structured. RT19 are open-structure, and others are semi-concealed structure. There are five fuse sizes available to choose from for the same fuse base of RT18N、RT18B、and RT18C. There are two sets of in-out lines for RT18N. One is installed with fuse links of the according size. The other is a permanent open contacts with double breaking points. The whole base unit can cut the power. RT18 bases are all DIN rail installed, among which the RT18L is equipped with safety lock against wrong operation in the breaking state.

Basic Data

The models, rated insulate voltage, rated current, and dimensions are shown in Figures 10.1~10.12 and Table 10 (Width of N-phase combination is $B_n = nB$).